



**totarasprings**

*a great place to grow*

# A VISION TO GROW

## NEW CABINS PROJECT CASE STATEMENT

*"We are a Christian camp that brings God's love to each person who visits. We are especially committed to serving our guests with outstanding hospitality."*

TOTARA SPRINGS CHRISTIAN CENTRE  
288C TAIHOA NORTH RD, R.D.3 MATAMATA  
07 888 4700 [WWW.TOTARASPRINGS.ORG.NZ](http://WWW.TOTARASPRINGS.ORG.NZ)

# a great place to grow

## LET'S GET READY FOR THE NEXT GENERATIONS TO COME!

**Lives are changed** when the gospel of Jesus Christ is shared. A Totara Springs experience provides a unique opportunity to receive God's love and encounter the gospel in very special surroundings.



For some, coming to camp means stepping away from the burdens of the world to reconnect with God. For others, it means **finding God for the very first time**, while building friendships and enjoying a broad variety of outdoor experiences. Either way, that's what Totara Springs Christian Centre (TSCC) is all about.

Through various programs, we offer young and old alike an opportunity to get to know God and learn how to trust in Him, to serve others, and to lead. We train our interns and volunteers to be Christian witnesses in the wider community. Our programs offer family & holiday camps where they can grow closer to each other and to God. We facilitate school groups & sports camps where students can leave the confines of the city, **disconnect from cell phones, video games and the internet, and explore the wonders of God's great natural world**. TSCC also hosts churches and other organizations who utilize our beautiful camp and resources for the enrichment of their community and families.

We are a Christian camp that brings God's love to each person who visits. We are especially committed to serving our guests with outstanding hospitality. On the pages that follow enjoy reading some of the reflections from TSCC participants about their own experiences.

**Chris Kinman**  
**Chief Executive Officer**



*When I was a camper, my leaders inspired me. As a leader my campers inspired me. Then there's all the other inspirational people you meet. It's like a never ending circle of inspiration.*

**– LEADER**

## LIFELONG IMPACT ON THOUSANDS OF LIVES

*“A camper was talking about the generational impact camp is having on his family. His older brother came to camp, now he’s at camp and he’s excited that his baby brother will come someday. Hearing this was really encouraging that we are changing the lives of whole families.”*

**– LEADER**

*“A camper was talking about the generational impact camp is having on his family. His older brother came to camp, now he’s at camp and he’s excited that his baby brother will come someday. Hearing this was really encouraging that we are changing the lives of whole families.”* - Leader

**– LEADER**

*“I love being a leader because of all the amazing opportunities there are to share God’s love to the kids. Seeing them having so much fun that they don’t want to go home afterwards is a bonus.”*

**– LEADER**

*“I really liked being a leader because for a week I was able to hang out with a group of girls and speak truth into their lives. Sitting with someone as they accept Jesus into their heart is one of the beautiful things. Being an area head is rewarding, as I get to walk alongside a group of leaders and support and encourage them as they grow and develop in their faith and leadership skills.”*

**– LEADER**



# TOTARA SPRINGS LEGACY & FUTURE

Totara Springs Christian Centre (TSCC) is the largest Centre of its kind in New Zealand and is the ultimate venue for church retreats, school camps, sports activities, business conferences, artistic events, holiday camps, and family reunions.

Now in its sixth decade, the site is very popular and has many wonderful attributes but there are some areas and buildings that are tired and do not allow for further growth. The Centre has undergone a process of master-planning for the future and has plans to replace and upgrade several key facilities.

TSCC engaged MAKE Architects to develop our masterplan and has provided the current concept design of a new multi-wing cabin block with central shared ablution facilities, towel drying rooms, and separate Parent/Teacher cabins with en-suite facilities. The four separate cabin wings are connected by open air covered walkways around sheltered green courtyard spaces.

This new Cabin Block is Stage 1 of 3 major projects, which also include replacement of the swimming pool and ablutions complex, and a new 1000-1200 seat entrance meeting hall and adjacent bus bay and parking.

The existing cabins at TSCC were part of the original buildings constructed when camp first started. A few years ago an extra cabin room was added onto the ends of each of the cabins to increase capacity. Now, as we face the decision of continuing to renovate the original cabins we have realised that they are not fit for purpose. In light of the age of the existing buildings in combination with new building codes, this new building project will be our most cost effective solution.

The new cabins will give our guests comfortable accommodation all year round and provide them with much needed rest so they are able to hear the good news of Jesus. The cabins are our most used accommodation and have seen tens of thousands of people come through them since 1967.

As we develop this new block we will be upgrading the infrastructure including drinking water storage, storm water, and wastewater systems. All of this will setup TSCC for future growth.

We are strategically relocating the new cabin block to be further out so when we remove the existing cabins we are able to grow the heart of the centre into a place of fun and relaxation. This will allow for beautiful lines-of-sight to the Kaimais, create more green space for freetime activities for children, and increase space for adults to interact while still keeping eyesight of children.

All of this will enable us to make better use of the space we have, creating an environment that opens people up to the mission and ministry of TSCC.

# SITE DEVELOPMENT MASTERPLAN



# CABIN BLUEPRINTS

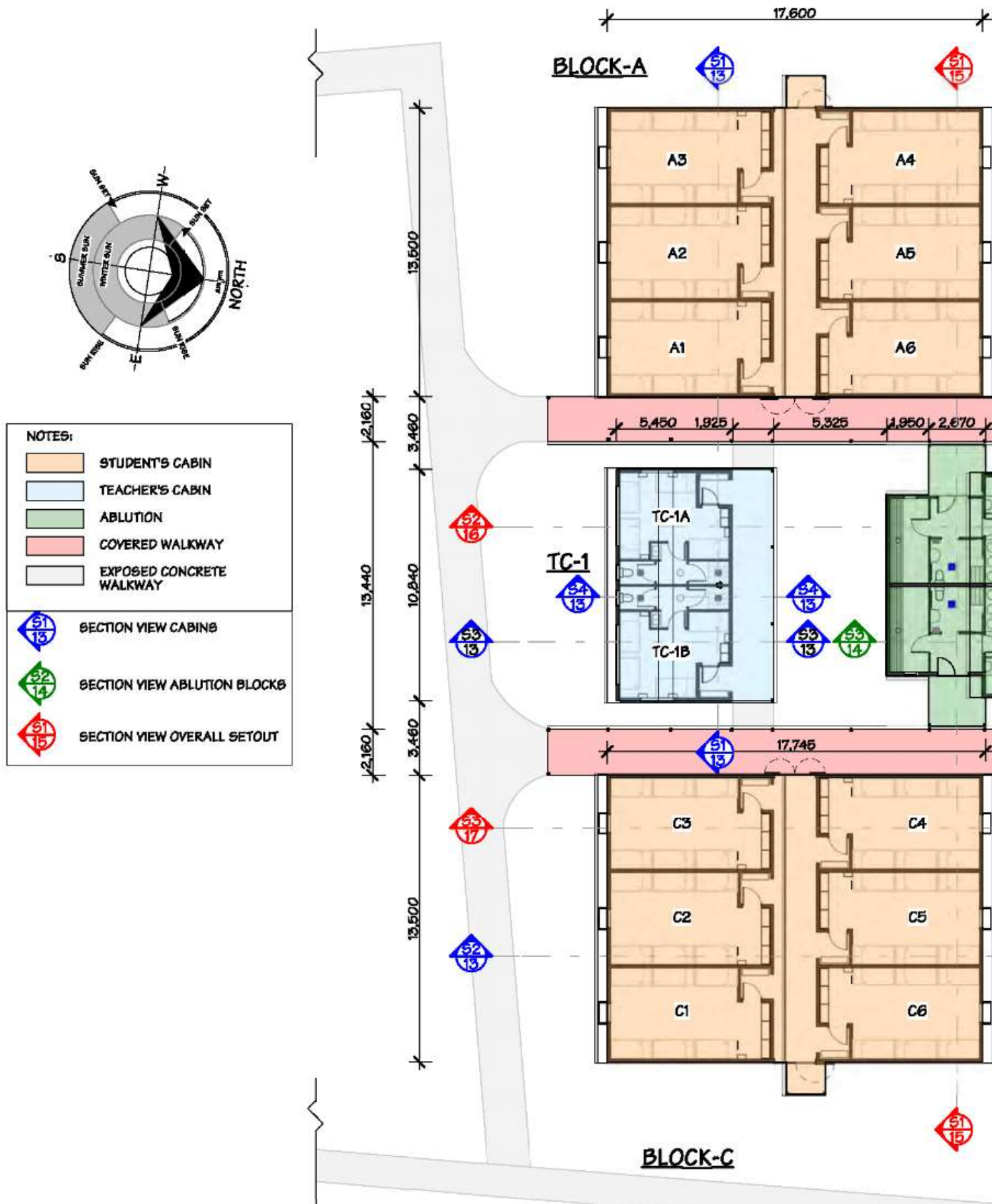
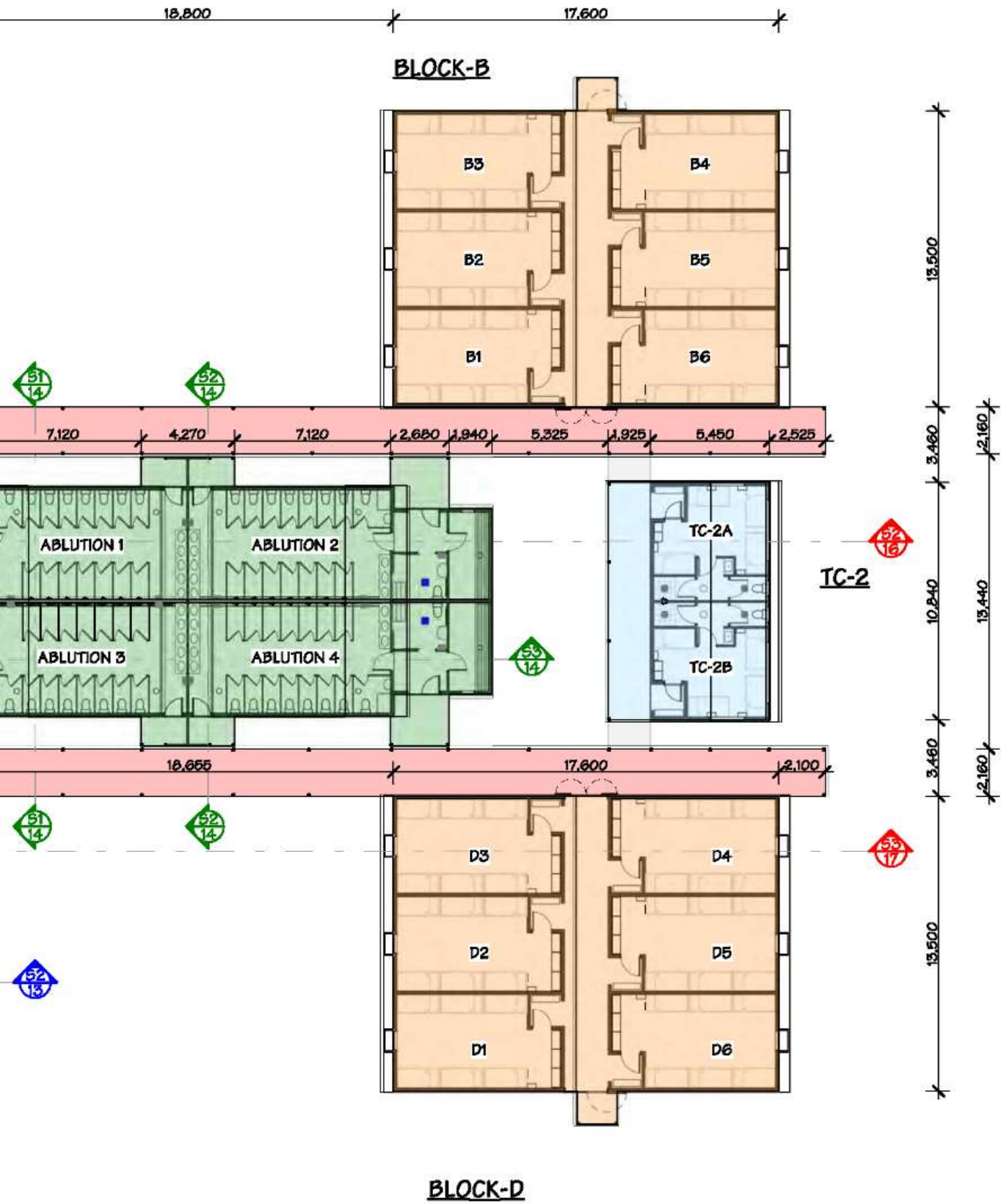

Figure 1. TSCC Cabin Complex Layout

# CABIN BLUEPRINTS



# NEW CABINS & FUTURE PROJECTS





# SITE DEVELOPMENT MASTERPLAN

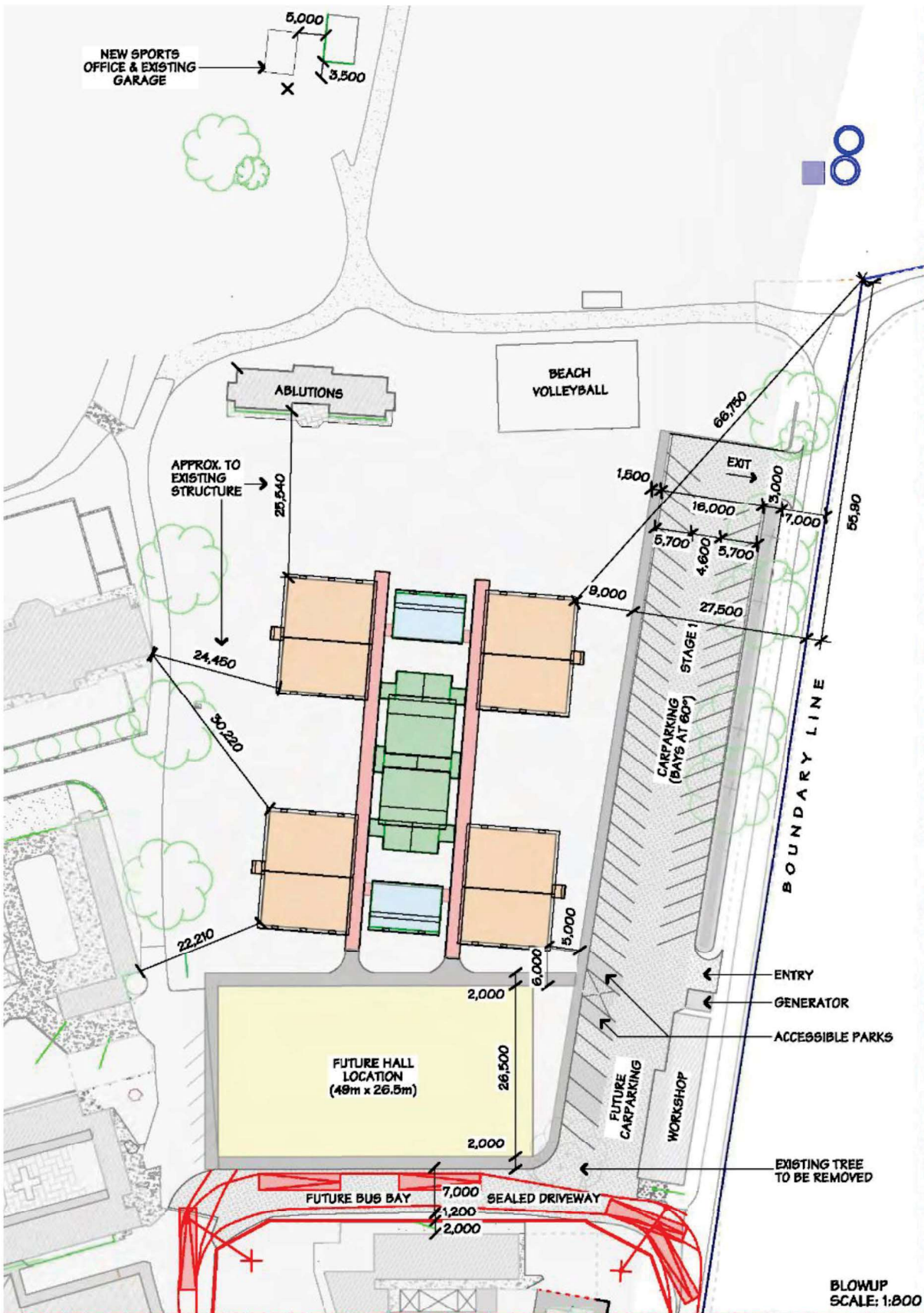

# HELP US MEET THE NEED

There are many ways to be a part of this project. Please consider partnering with us to complete this project which will impact thousands of lives over the coming years. Your contribution will be a part of a larger community of donors who want to see this project to completion. Whether you make a one time pledge or give monthly, your gift will matter. Thank you for joining us in this great cause to impact lives at Totara Springs today and for future generations to come.

**I want to give, what do I do next?** You can go to our website and click on “Donate” under the “Get Involved” tab for more details. Choose to give one-time or monthly via Direct Deposit, Cheque, In Person, or Donate online option.

**Can I claim a tax credit for my donation?**

Yes, if you make a donation to a charity or other organisation that has donee status. Donee status is administered by Inland Revenue. Totara Springs is registered with Charities Services and is eligible for donee status. *Totara Springs Christian Centre Limited CC56824*

If your employer offers payroll giving, and you make donations to a donee organisation directly from your pay, you will receive an immediate tax credit on the amount of your donation.

**Can I leave a gift in my will?**

Yes, it's a common misconception that only wealthy people leave money to charity when they die. Gifts in wills, or bequests, are not just made by the rich and famous. The reality is that most bequests are made by ordinary, hardworking people who want to make a positive difference in their community and to other people's lives.

[www.totarasprings.org.nz](http://www.totarasprings.org.nz)

**Direct deposit**

**02-0316-0572654-00**

**Reference: Cabin Project**



# GIFT RANGE CHART

## A VISION TO GROW THE FUNDING PLAN

Below we see approximate numbers and sizes of gifts required to meet a fundraising campaign goal of \$5,000,000. We realize the actual gifts won't match this chart exactly, but it roughly matches a way that will get us to our target..

Perhaps this chart can help you decide where you would like your gift to fit into the Total Goal amount needed.

Gift Levels	Number of Gifts Required	Gift Amounts	\$ Per Level	Cumulative Amount
Lead Gifts	1	\$750,000	\$750,000	\$750,000
	1	\$500,000	\$500,000	\$1,250,000
	3	\$250,000	\$750,000	\$2,000,000
	6	\$100,000	\$600,000	\$2,600,000
Advanced Gifts	15	\$50,000	\$750,000	\$3,350,000
	25	\$25,000	\$625,000	\$3,975,000
	40	\$10,000	\$400,000	\$4,375,000
Major Gifts	50	\$5,000	\$250,000	\$4,625,000
	75	\$2,500	\$187,500	\$4,812,500
	100	\$1,000	\$100,000	\$4,912,500
Community Gifts	140	\$500	\$70,000	\$4,982,500
	175	\$100	\$17,500	\$5,000,000
Total # of Gifts	<b>631</b>		<b>Total Goal</b>	<b>\$5,000,000</b>



*"We are a Christian camp that brings God's love to each person who visits. We are especially committed to serving our guests with outstanding hospitality."*

# PROJECT DETAILS

The objective for this project is to build a new cabin complex on the site of the current football field to allow expansion and re-development of the hub area of camp. This new cabin complex will replace the existing Rata & Manuka U-shaped cabin blocks (220 beds total), adding an additional 100 beds. The old cabins will eventually be demolished or partly remodelled for other facilities once the new complex is complete.

The new complex includes:

- Cabin accommodation consists of 4 separate blocks, each block consisting of two separated building rows of 3 bunk rooms each, typically 12 beds per room with storage and changing area per cabin.
- Total of 24 new rooms with 288 beds – 24 of these beds may be double occupancy. Teacher/Family accommodation consists of 2 separate blocks of 2 rooms each with en-suite facilities, typically 4 beds per room (maximum of 6 beds per room). Total of 4 new rooms with 16 beds (maximum of 24 beds).  
Total number of proposed beds = 304, (with possible maximum number of occupants = 336).
- Ablution facilities and towel drying rooms consists of four separate blocks with 9 toilets and 8 showers per block including accessible facilities.  
Total number of proposed toilets = 40. Total number of proposed showers = 36.



# NEW CABINS & INFRASTRUCTURE

- Covered Walkways to connect cabin complex facilities and to connect the Cabin complex to the adjacent proposed new Meeting Hall and Busbay.
- Car Parking Lot to the East of the complex for approximately 50 vehicles including accessible parking and entry and exit ways from the eastern boundary road. This carpark can be extended further south in the proposed Meeting Hall and Busbay Project.

As part of the new Cabin Complex Project significant infrastructure works will be undertaken for the water, wastewater, and stormwater systems to meet the needs of the new project and to futureproof for the proposed master plan projects.

- These works include:
  - new water main line from the recently replaced potable water storage tanks through the new cabin complex and connection into the existing main junction;
  - new large wastewater septic tanks with main lines and pump station upgrades to include emergency storage tanks;
  - new stormwater swales and pipe lines to connect to the existing outfall catchment system.

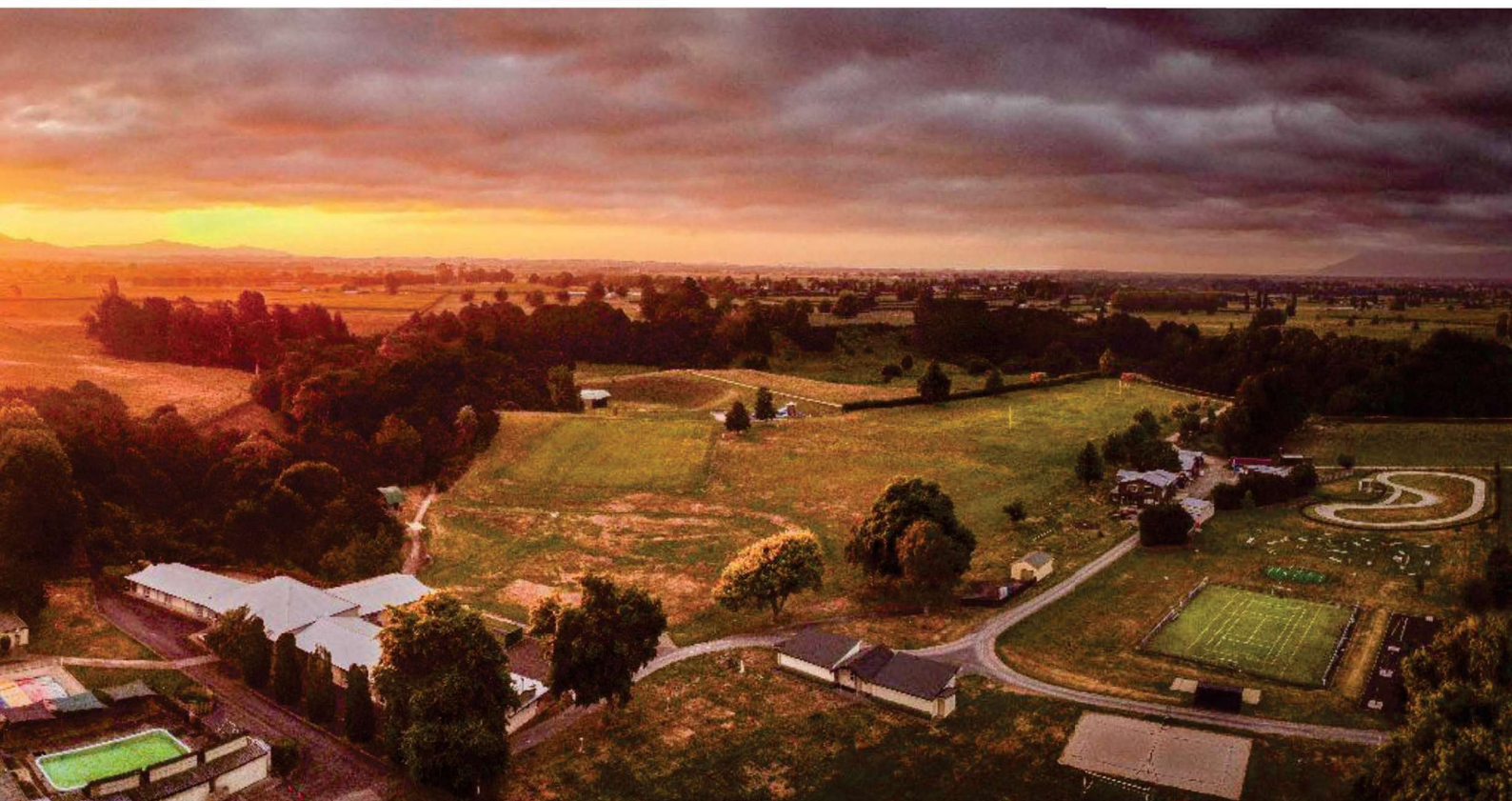





# FROM THE 1960's...



Totara Springs Eastern Waikato below Kaimai Ranges

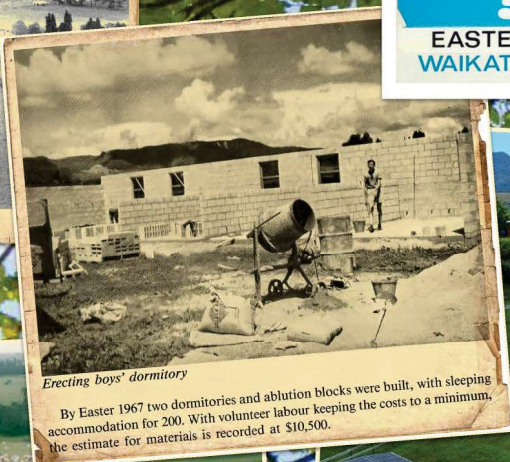

Erecting boys' dormitory

By Easter 1967 two dormitories and ablution blocks were built, with sleeping accommodation for 200. With volunteer labour keeping the costs to a minimum, the estimate for materials is recorded at \$10,500.

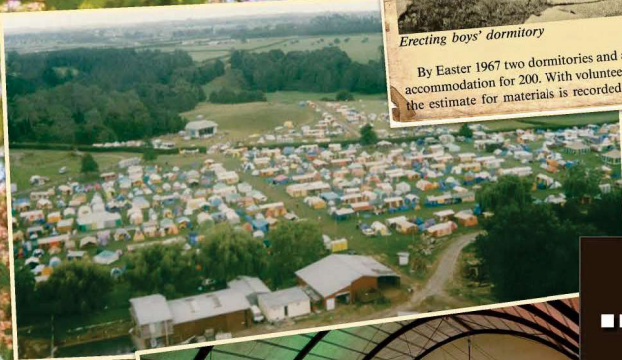
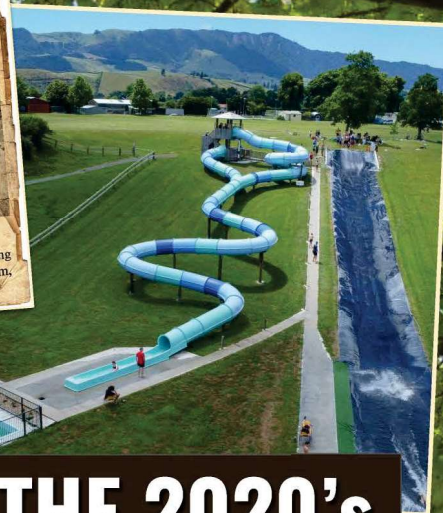

# ...INTO THE 2020's AND BEYOND...



christian  
camping  
NEW ZEALAND